

MULTIPIN DXN25c/DXN37c

Product Features



Locking Provision

For insertion of locking pin (or padlock) to prevent inadvertent disconnection

Metal Casing

Provides excellent durability and protection.

Lid

Provides additional protection from harsh environments.

Silver-Nickel Contacts

Silver-nickel contact material provides superior conductivity, durability and corrosion resistance.

Recessed Contacts

Provides IP2X protection from live electrical parts.

Spring Loaded Butt-Style Contacts

Ensures optimal contact force and superior electrical performance over thousands of operations.

IP66+IP67 Watertightness

Environmental rating is achieved as soon as the plug is latched to the receptacle. There is no additional ring to tighten.

Hazardous Duty Listings

ATEX

II 2 G/D Ex de IIC tD A21 IP66/IP67
Suitable for Zone 1 & 2 (gas) 21 & 22 (dust)

DXN25c -40°C ≤ Ta ≤ 60°C T5 T71°C
-40°C ≤ Ta ≤ 40°C T6 T51 °C

DXN37c -40°C ≤ Ta ≤ 55°C T5 T76°C
-40°C ≤ Ta ≤ 40°C T6 T56 °C



New Feature – DXN37c ONLY!

• Crimped Contacts

DXN37c devices now feature contacts that can be crimped or soldered. Each device is supplied with 39 contacts so that the product can be set up to suit application needs. (DXN25c devices will feature crimped contacts in 2014 or earlier).

Simple Assembly and Disassembly

DSN37c shown

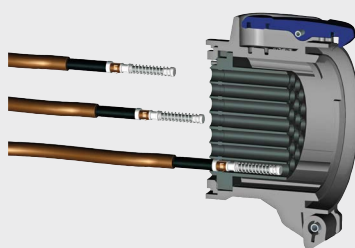

Assembly

To insert contacts when they have been wired is simple. Push wired contact into rear of insulator until it stops to complete the installation.

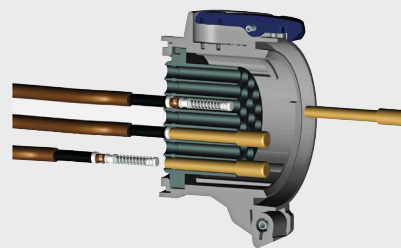

Disassembly

To remove, use the tool provided. Push tool from front onto contact until tool stops. Contact is then released at rear of insulator.

DXN25c / DXN37c – 10A

Hazardous Location Plugs & Receptacles

DXN25c
DXN37c

Connector (female receptacle w/handle)



or

Receptacle/Angle (female)



or

Receptacle /Angle/Box (female)



Voltage	Polarity	Cable Range	Part # Metal	Part # Metal	Part # Metal
440V	24P+G	(.50" - .825")	36-D3002-32M	36-D7002	36-D0002-32M
440V	24P+G	(.63" - 1.05")	36-D3002	36-D7002	36-D0002
230V	36P+G	(.50" - .825")	36-C3003-32M	36-C7003	36-C0003-32M
230V	36P+G	(.63" - 1.05")	36-C3003	36-C7003	36-C0003

Plug (male inlet w/handle)



or

Inlet/Angle (male)



or

Inlet/Angle/Box (male)



Voltage	Polarity	Cable Range	Part # Metal	Part # Metal	Part # Metal
440V	24P+G	(.50" - .825")	36-D1002-32M	36-D9002	36-D6002-32M
440V	24P+G	(.63" - 1.05")	36-D1002	36-D9002	36-D6002
230V	36P+G	(.50" - .825")	36-C1003-32M	36-C9003	36-C6003-32M
230V	36P+G	(.63" - 1.05")	36-C1003	36-C9003	36-C6003

Ratings

- Voltage**
440 VAC or VDC DXN25c
230 VAC or VDC DXN37c
- Amperage Ratings**
10A DXN25c Not for disconnection of a live circuit
10A DXN37c Not for disconnection of a live circuit
- Environmental Ratings**
IP66+IP67
- Temperature Range**
Min -40°F/Max 140°F – (DXN25c)
Min -40°F/Max 131°F – (DXN37c)
- Wiring Capacity**
Min 16 AWG Max 14 AWG
* Based on THHN wiring connection type solder
- Terminal Type**
DXN25c: Solder/Crimp
DXN37c: Solder/Crimp
- Listings**
ATEX

Accessories

Mult-Contact Removal Tool

Part # 9-LD12-37

European Crimping Tool

Part # 61-CA500

Spare Bag of 13 Female Contacts*

Part # 01-AA213

Spare Bag of 13 Male Contacts*

Part # 61-CA113

* Includes insulation sleeves and ferrules.

Dimensions

Receptacle – Provided in inches

Dimensions are for reference only and may change depending on accessories used. For precise dimensions contact Meltric Engineering.

connector

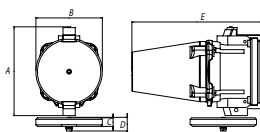

PRODUCT	A	B	C	D	E
DXN25c/37c	4.49	3.35	.43	.71	6.57

plug

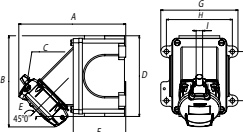

PRODUCT	A	B	C
DXN25c/37c	3.43	3.19	5.83

receptacle / angle / junction box

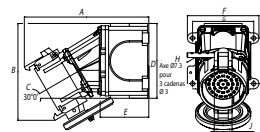

PRODUCT	A	B	C	D	E	F	G	H	I	J
DXN25c/37c	7.52	5.87	4.53	2.95	4.33	3.7	2.76	1.06		