

# CS1000

**NEW  
Product**

Features and Ratings p. 138

CS1000 p. 139

Dimensions p. 140



## Single Pole Power Connectors

The CS1000 devices are designed to be a new industry standard for safety, usability, reliability, performance and durability. The CS1000 Series provides safety features that are not currently offered by other single pole devices. These safety features include: IP2X finger protection that protects users from live parts, mechanical keying system prevents insertion of the wrong phases, a locking pin that prevents accidental disconnection, and a plug/receptacle that accepts different cable sizes. The standard features of CS1000 Series include solid silver-nickel contacts, spring-loaded, butt-style contact technology and IP66 + IP67 environmental protection.

### Main Advantages

- ▶ High Amperage Capacity up to 400A, 1000VAC.
- ▶ Safety features protect users from live parts and prevent unwanted disconnection.
- ▶ Silver-nickel butt contacts provide superior performance and corrosion resistance.

# Product Features



## Operating Instructions

### Connection

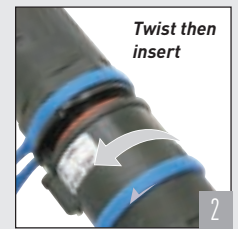
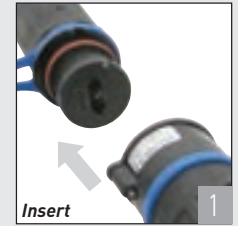

### Disconnection



## General Ratings

Amperage	400A
Voltage	1000 VAC, 1500 VDC
Frequency	50-400 Hz
Environmental	IP66/IP67
Temperature	min -40°F/max 185°F

## Highlighted Feature

5 Mechanical Keying Positions  
(North America color codes shown.)

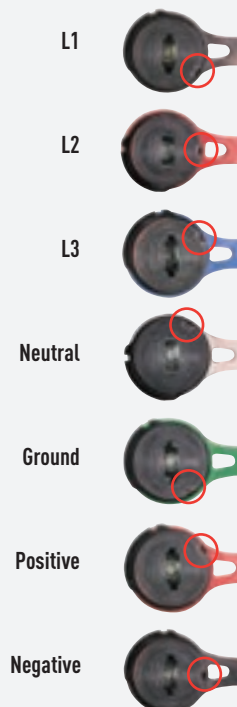

CS1000

# CS1000 – 400A - 1000 VAC

## Standard Duty Plugs & Receptacles

### Ratings

- **Amperage**  
400A
- **Voltage**  
1000 VAC, 1500 VDC
- **Environmental Ratings**  
IP66+IP67
- **Temperature Range**  
Min -40°F / Max 140°F
- **Wiring Capacity**  
Min 1/0 AWG / Max 450 MCM
- **Listings**  
Consult Factory

### Recommendation

Use these part numbers if the devices will be utilized in North America.

### Recommendation

Use these part numbers if the devices will be utilized in Europe.

### Receptacle (female) without lug



Don't forget to add installation accessories to your order



North American Color Code	Polarity	Part # without lug
	L1	45-34001-P80
	L2	45-34002-P80
	L3	45-34003-P80
	NEUTRAL	45-3400N-P80
	GROUND	45-3400T-P80
	POSITIVE	45-3400P-P80
	NEGATIVE	45-3400M-P80

European Color Code	Polarity	Part # without lug
	L1	45-34001
	L2	45-34002
	L3	45-34003
	NEUTRAL	45-3400N
	GROUND	45-3400T
	POSITIVE	45-3400P
	NEGATIVE	45-3400M

### Inlet (male) without lug



North American Color Code	Polarity	Part # without lug
	L1	45-38001-P80
	L2	45-38002-P80
	L3	45-38003-P80
	NEUTRAL	45-3800N-P80
	GROUND	45-3800T-P80
	POSITIVE	45-3800P-P80
	NEGATIVE	45-3800M-P80

European Color Code	Polarity	Part # without lug
	L1	45-38001
	L2	45-38002
	L3	45-38003
	NEUTRAL	45-3800N
	GROUND	45-3800T
	POSITIVE	45-3800P
	NEGATIVE	45-3800M

### Angle Options



Adapter  
Plate Only

Part #

Adapter Plate 45-3A540



Inclined Angle  
30° with  
Adapter Plate

Part #

30° Angle 45-3A027

## Installation Accessories

### Angles



w/Adapter Plate

Angle 30°

45-3A027



Required for mounting  
on panels, walls, etc.

Adapter  
Plate

45-3A540

### Accessories



Inlet Cap

45-3A126



Unlocking Tool \*

45-3A396



Padlocking  
Tool

45-3A844

\* One unlocking tool on a "valet" style separable key ring is included with each male inlet

## Installation Accessories

### Crimping lug

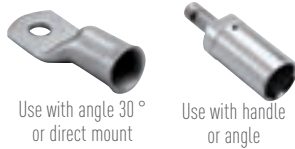

Measured Internal Dia. (in)	Flexible Wire Size	Straight with Terminal	Straight Threaded
.43	1/0	45-3A50C	45-3A50D
.52	3/0	45-3A70C	45-3A70D
.57	4/0	45-3A95C	45-3A95D
.64	250	45-3A12C	45-3A12D
.70	300	45-3A15C	45-3A15D
.80	350	45-4A18C	45-4A18D
.90	450	45-4A24C	45-4A24D

### Handle



Cable Outside Diameter	Part #
.550 - 1.000	45-3A753
.700 - 1.260	45-3A783

### Handle w/Cord Grip (Mesh)



Cable Outside Diameter	Part #
.500 - .625	45-3A753-A
.562 - .688	45-3A753-B
.625 - .750	45-3A753-C
.688 - .812	45-3A753-D
.750 - .875	45-3A753-E
.875 - 1.000	45-3A783-A
1.000 - 1.125	45-3A783-B
1.125 - 1.250	45-3A783-C
1.250 - 1.375	45-3A783-D

## Dimensions Provided in inches

Dimensions are for reference only and may change depending on accessories used. For precise dimensions contact Meltric Engineering.

### receptacle

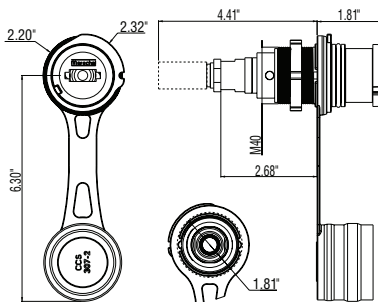

### plug/receptacle

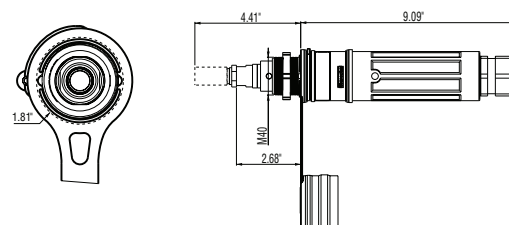

### inline connector

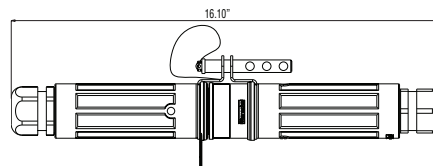

### 30° inclined receptacle/angle

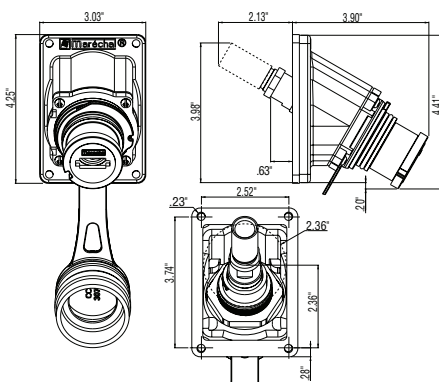

### 30° receptacle/angle with plug

