

U-Reel

Single Hose, General Purpose Reels
with Increased Flexibility and Value

Unique Modular
Design... You always get
a reel that exactly fits
your needs.



Air Hose Reels

Lift Capacities based on speed of 150 ft/min. and acceleration of 0.50 ft/sec².

NOTE: Consult factory for capacities greater than 120 feet.

FEET OF HOSE	HOSE I.D.					
	3/8"	1/2"	3/4"	1"	1-1/4"	1-1/2"
20	UH18351-06-1406-2	UH18351-08-1206-4	UH18751-12-1008-1	UH21751-16-1208-1	UH241001-20-1410-1	UH28752-24-1610-3
30	UH18351-06-1406-2	UH18351-08-1206-4	UH18751-12-1008-1	UH21751-16-1208-1	UH241001-20-1410-1	UH28752-24-1610-3
40	UH18351-06-1406-2	UH18351-08-1006-2	UH21751-12-1008-1	UH24751-16-1208-1	UH241001-20-1410-1	UH28752-24-1610-3
50	UH18351-06-1406-2	UH18621-08-1006-1	UH21801-12-1008-1	UH24751-16-1208-1	UH281001-20-1410-4	UH321002-24-1610-1
60	UH18621-06-1406-1	UH21801-08-1406-1	UH21801-12-1008-1	UH241001-16-1208-1	UH281002-20-1410-1	UH321002-24-1610-1
70	UH18621-06-1206-1	UH21801-08-1406-1	UH24801-12-1008-1	UH28802-16-1208-2	UH281002-20-1410-1	UH321002-24-1610-1
80	UH18621-06-1206-1	UH21801-08-1206-1	UH21801-12-1008-1	UH24801-16-1208-2	consult factory	UH321002-24-1610-1
90	UH18621-06-1006-1	UH24801-08-1406-1	UH28802-12-1008-A-5	UH28802-16-1208-2	consult factory	consult factory
100	UH24801-06-1806-1	UH24801-08-1406-1	UH28802-12-1008-A-5	UH321002-16-1208-A-1	consult factory	consult factory

Stretch Capacities based on 10% sag, speed of 150 ft/min. and acceleration of 0.75 ft/sec².

FEET OF HOSE	HOSE I.D.					
	3/8"	1/2"	3/4"	1"	1-1/4"	1-1/2"
20	UH18351-06-1406-2	UH18351-08-1206-3	UH18751-12-1008-1	UH21751-16-1208-1	UH24751-20-1410-4	UH281001-24-1610-1
30	UH18351-06-1406-2	UH18351-08-1206-3	UH18751-12-1008-1	UH21751-16-1208-1	UH24751-20-1410-4	UH281001-24-1610-1
40	UH18351-06-1406-2	UH18351-08-1006-2	UH21751-12-1008-1	UH24751-16-1208-1	UH24751-20-1410-4	UH281001-24-1610-1
50	UH18351-06-1406-2	UH18621-08-1006-1	UH21801-12-1008-1	UH24751-16-1208-1	UH281001-20-1410-1	UH321001-24-1610-5
60	UH18621-06-1406-1	UH21801-08-1406-1	UH21801-12-1008-1	UH241001-16-1208-1	UH281001-20-1410-1	UH32752-24-1610-2
70	UH18621-06-1206-1	UH21801-08-1406-1	UH24801-12-1008-1	UH28802-16-1208-1	UH281001-20-1410-1	UH321002-24-1610-1
80	UH18621-06-1206-1	UH21801-08-1206-1	UH24801-12-1008-1	UH28802-16-1208-1	UH321002-20-1410-A-3	UH321002-24-1610-1
90	UH18621-06-1006-1	UH24801-08-1406-1	UH28802-12-1008-A-2	UH28802-16-1208-1	UH321002-20-1410-A-3	consult factory
100	UH24801-06-1806-1	UH24801-08-1406-1	UH28802-12-1008-A-2	UH32802-16-1208-1	consult factory	consult factory

Retrieve Capacities based on 3 ft. mounting height, speed of 150 ft/min. and acceleration of 1.0 ft/sec².

FEET OF HOSE	HOSE I.D.					
	3/8"	1/2"	3/4"	1"	1-1/4"	1-1/2"
20	UH18351-06-1406-3	UH18351-08-1206-4	UH18351-12-1008-5	UH21751-16-1208-1	UH24751-20-1410-2	UH28751-24-1610-2
30	UH18351-06-1406-3	UH18351-08-1206-4	UH18351-12-1008-5	UH21751-16-1208-1	UH24751-20-1410-2	UH28751-24-1610-2
40	UH18351-06-1406-3	UH18621-08-1006-2	UH21751-12-1008-1	UH24751-16-1208-1	UH24751-20-1410-2	UH28751-24-1610-2
50	UH18351-06-1406-3	UH18621-08-1006-2	UH21621-12-1008-3	UH24751-16-1208-1	UH28751-20-1410-2	UH32751-24-1610-3
60	UH18621-06-1406-2	UH21621-08-1406-2	UH21621-12-1008-3	UH24801-16-1208-2	UH28801-20-1410-4	UH321001-24-1610-2
70	UH18621-06-1206-2	UH21621-08-1406-2	UH24621-12-1008-5	UH28801-16-1208-3	UH28801-20-1410-4	UH321001-24-1610-2
80	UH18621-06-1206-2	UH21621-08-1206-2	UH24621-12-1008-5	UH28801-16-1208-3	UH32802-20-1410-2	UH32802-24-1610-3
90	UH21621-06-1406-2	UH21621-08-1206-2	UH28622-12-1008-2	UH28801-16-1208-3	UH32802-20-1410-2	consult factory
100	UH21621-06-1206-2	UH21621-08-1006-2	UH28622-12-1008-2	UH32622-16-1208-4	UH32802-20-1410-2	consult factory

U-Reel Dimensional Guide

All dimensions in inches. For millimeters, multiply inches by 25.4.

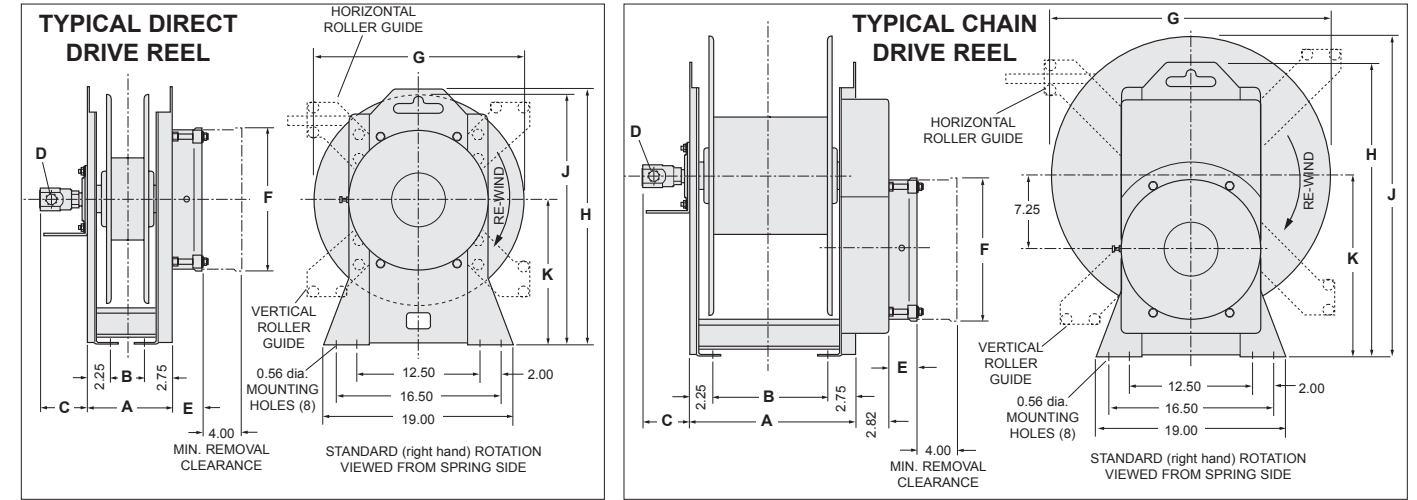

To find dimensions for the model reel you require, you must know:

- Spool Diameter and Width
- Hose I.D.
- Model of Spring(s)
- Quantity of Spring(s) in Motor
- Whether Reel is Direct Drive or Chain Drive

REEL WIDTH DIMENSIONS

SPOOL WIDTH	OVERALL FRAME "A"	MOUNTING HOLES "B"
6.00	10.50	5.50
8.00	12.50	7.50
10.00	14.50	9.50
12.00	16.50	11.50
14.00	18.50	13.50

OVERALL SIZE

SPOOL DIA. "G"	FRAME HEIGHT "H"	SPOOL HEIGHT "J"	SPOOL CENTER "K"	WEIGHT* "Y" lbs.
18	24.25	22.00	13.00	84
21	25.75	25.00	14.50	91
24	27.25	28.00	16.00	100
28	29.25	32.00	18.00	115
32	31.25	36.00	20.00	140

SPRING MOTOR DIMENSIONS

MODEL SPRING	QUANTITY SPRING(S) IN MOTOR	MOTOR WIDTH "E"	MOTOR DIAMETER "F"	WEIGHT* "Y" lbs.
35	1	2.50	10.25	20
62	1	3.00	14.34	40
62	2	5.63	14.34	80
75	1	3.00	10.25	33
75	2	5.63	10.25	66
80	1	3.00	14.34	44
80	2	5.63	14.34	88
100	1	4.00	14.34	64
100	2	7.62	14.34	129

HOSE SIZE DIMENSIONS

HOSE CODE	HOSE I.D.	SWIVEL "C"	"D"
06	3/8	3.00	3/8 NPT
08	1/2	3.12	1/2 NPT
12	3/4	3.25	3/4 NPT
16	1	4.12	1 NPT
20	1-1/4	4.36	1-1/4 NPT
24	1-1/2	6.50	1-1/2 NPT

Find the dimensions for the known factors and plug them into the drawings above. Dimensions already on the drawings are the same for all models. All dimensions in inches.

*Note: Total weight is sum of "X" and "Y" plus 55 lbs. if chain drive reel. All weights in pounds. For Kg, multiply pounds by 0.45.

340° Pivot Base

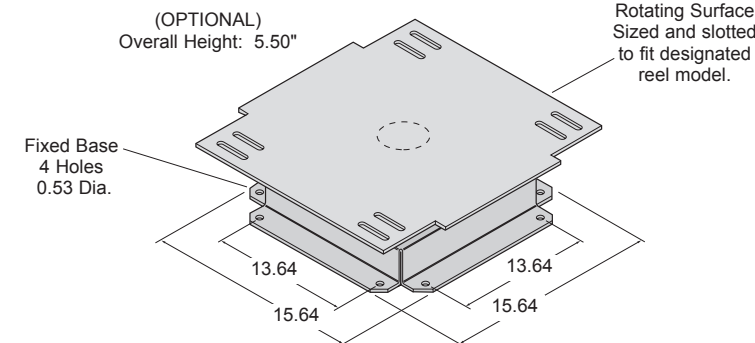

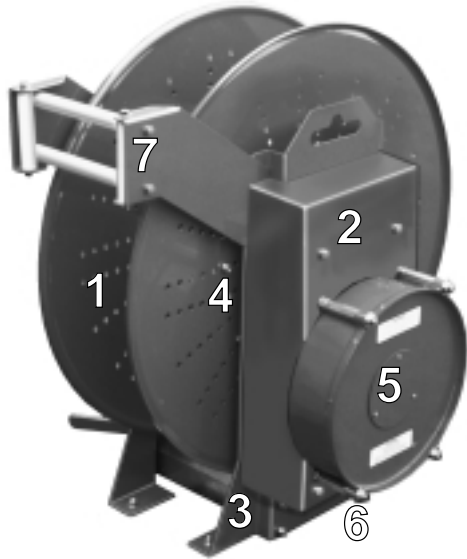

Standard Features

- 300 PSI standard rating (ratings to 10,000 PSI available)
- 1. Wide or Narrow spool
- 2. Direct or Chain Drive.
- 3. Rugged U-shaped frame
- 4. Dual supported spool on over-sized bearings. Not cantilevered.
- 5. Safetychange® Spring Motor makes replacement safe and easy.
- 6. Optional 340° Pivot Base (not shown).
- 7. Optional Roller Guide accommodates a variety of mounting configurations.
- Ratchet Lock

Liquid Hose Reels

Lift Capacities based on speed of 150 ft/min. and acceleration of 0.50 ft/sec².

NOTE: Consult factory for capacities greater than 120 feet.

FEET OF HOSE	HOSE I.D.					
	3/8"	1/2"	3/4"	1"	1-1/4"	1-1/2"
20	UH18351-06-1406-5	UH18351-08-1006-5	UH18751-12-1008-1	UH21751-16-1208-5	UH24752-20-1410-5	UH281002-24-1610-7
30	UH18351-06-1406-5	UH18351-08-1006-5	UH18751-12-1008-1	UH21751-16-1208-5	UH24752-20-1410-5	UH281002-24-1610-7
40	UH18351-06-1406-5	UH18801-08-1006-1	UH21751-12-1008-1	UH241001-16-1208-2	UH241002-20-1410-1	UH281002-24-1610-7
50	UH18621-06-1006-1	UH18801-08-1006-1	UH21802-12-1008-1	UH241001-16-1208-2	UH281002-20-1410-2	consult factory
60	UH18621-06-1006-1	UH21801-08-1406-1	UH21801-12-1008-1	UH241002-16-1208-1	UH281002-20-1410-2	consult factory
70	UH18621-06-1006-1	UH21801-08-1406-1	UH24802-12-1008-1	UH281002-16-1208-A-4	consult factory	consult factory
80	UH18621-06-1006-1	UH21801-08-1206-1	UH24802-12-1008-1	consult factory	consult factory	consult factory
90	UH18621-06-1006-1	UH24801-08-1406-3	UH281002-12-1008-B-2	consult factory	consult factory	consult factory
100	UH24801-06-1806-1	UH21622-08-1006-1	UH281002-12-1008-B-2	consult factory	consult factory	consult factory

Stretch Capacities based on 10% sag, speed of 150 ft/min. and acceleration of 0.75 ft/sec².

FEET OF HOSE	HOSE I.D.					
	3/8"	1/2"	3/4"	1"	1-1/4"	1-1/2"
20	UH18351-06-1406-5	UH18351-08-1006-3	UH18751-12-1008-1	UH21751-16-1208-1	UH241001-20-1410-4	UH281002-24-1610-1
30	UH18351-06-1406-5	UH18351-08-1006-3	UH18751-12-1008-1	UH21751-16-1208-1	UH241001-20-1410-4	UH281002-24-1610-1
40	UH18351-06-1406-5	UH18351-08-1006-3	UH21751-12-1008-1	UH24751-16-1208-3	UH241001-20-1410-4	UH281002-24-1610-1
50	UH18621-06-1006-2	UH18801-08-1006-1	UH21801-12-1008-3	UH241001-16-1208-1	UH281002-20-1410-1	UH321002-24-1610-4
60	UH18621-06-1006-2	UH21801-08-1406-1	UH21801-12-1008-3	UH241001-16-1208-1	UH281002-20-1410-1	UH321002-24-1610-4
70	UH18621-06-1006-2	UH21801-08-1406-1	UH24802-12-1008-1	UH28802-16-1208-6	UH281002-20-1410-1	consult factory
80	UH18621-06-1006-2	UH21801-08-1206-1	UH24802-12-1008-1	UH281002-16-1208-A-1	consult factory	consult factory
90	UH21801-06-1406-1	UH24801-08-1406-2	UH281002-12-1008-B-1	UH281002-16-1208-A-1	consult factory	consult factory
100	UH24801-06-1806-2	UH21622-08-1006-1	UH281002-12-1008-B-1	consult factory	consult factory	consult factory

Retrieve Capacities based on 3 ft. mounting height, speed of 150 ft/min. and acceleration of 1.0 ft/sec².

FEET OF HOSE	HOSE I.D.					
	3/8"	1/2"	3/4"	1"	1-1/4"	1-1/2"
20	UH18351-06-1406-3	UH18351-08-1206-4	UH18351-12-1008-6	UH21751-16-1208-2	UH24751-20-1410-3	UH28751-24-1610-5
30	UH18351-06-1406-3	UH18351-08-1206-4	UH18351-12-1008-6	UH21751-16-1208-2	UH24751-20-1410-3	UH28751-24-1610-5
40	UH18351-06-1406-3	UH18621-08-1006-2	UH21751-12-1008-1	UH24751-16-1208-2	UH24751-20-1410-3	UH28751-24-1610-5
50	UH18351-06-1406-3	UH18621-08-1006-2	UH21621-12-1008-5	UH24801-16-1208-3	UH281001-20-1410-2	UH321001-24-1610-2
60	UH18621-06-1406-2	UH21621-08-1406-3	UH21621-12-1008-5	UH24801-16-1208-3	UH281001-20-1410-2	UH321001-24-1610-2
70	UH18621-06-1206-2	UH21621-08-1406-3	UH24801-12-1008-2	UH28801-16-1208-3	UH28802-20-1410-3	UH321001-24-1610-2
80	UH18621-06-1206-2	UH21621-08-1206-3	UH24801-12-1008-2	UH28801-16-1208-3	UH32802-20-1410-3	UH32802-24-1610-4
90	UH21621-06-1406-2	UH21621-08-1206-3	UH28622-12-1008-3	UH28801-16-1208-3	UH32802-20-1410-3	consult factory
100	UH21621-06-1206-2	UH24621-08-1406-3	UH28622-12-1008-3	UH32802-16-1208-2	UH32802-20-1410-3	consult factory